

# SKF/Gilman Metric Belt Driven Spindles

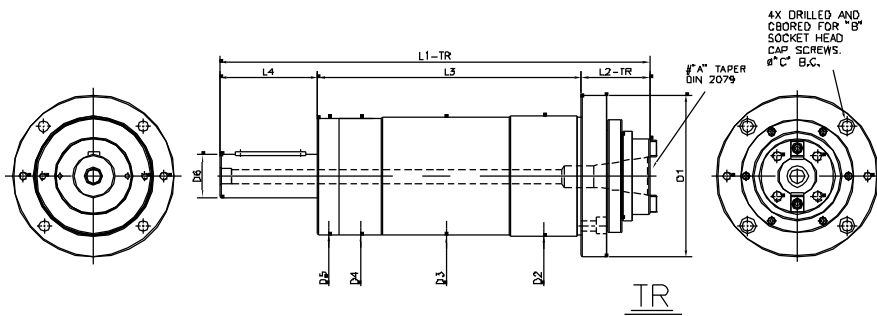

Spindle Size	L1-TR	L2-TR	L1-BN	L2-BN	L1-HM	L2-HM	D-BN
Tolerance	mm	mm	mm	mm	mm	mm	-0/+ 0.015 mm
90C	360	70	360	70	377	87	44.045
140C	505	80	505	80	526	101	56.045
200C	715	112.5	715.0	112.5	743	140.5	88.055

Spindle Size	A	B	C	E	F	G
Tolerance	mm	mm	mm	mm	mm	mm
90C	#30	M8	110	M6	63	50
140C	#40	M12	165	M8	79	63
200C	#50	M16	230.0	M10	119	100

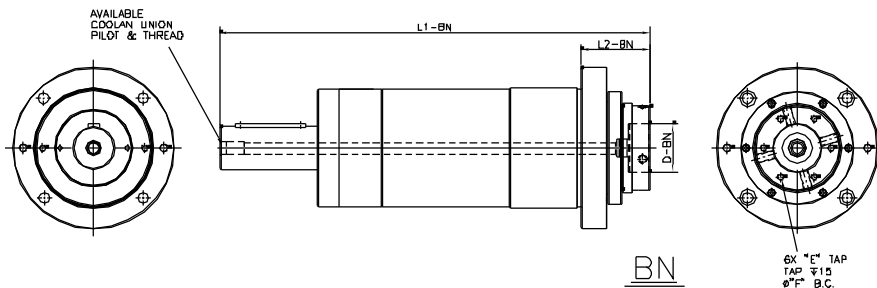

Spindle Size	L3	L4	D1	D2	D3	D4	D5	D6
Tolerance	mm	mm	mm	h5	mm	h5	+/-0.03 mm	h7
90C	200	90	130	90	88.5	87	86.90	30
140C	310	115	190	140	138.5	137	136.90	50
200C	475	127.5	260	200	198.5	197	196.90	60

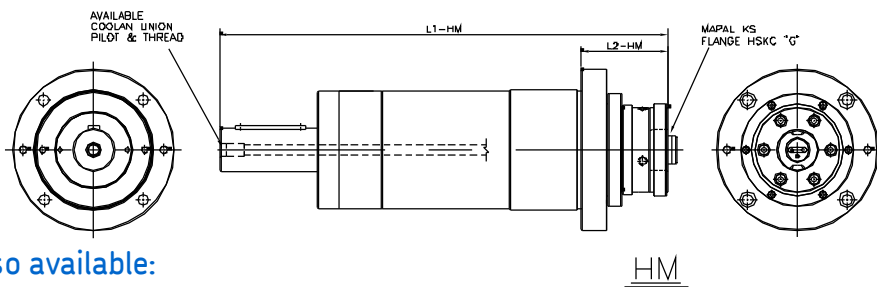

Also available:

- Cartridge mounting brackets.
- Block type spindles.

For more information or to request a dimensional drawing contact us at 800-445-6267 or [WWW.SKFP.T.COM](http://WWW.SKFP.T.COM)